

## New Battery for IMAG-CM and IMAG-CG from 2021 onwards

Ansmann Battery 4S2P 14.8V/5.2Ah - Walz Order Nr. 000160101441

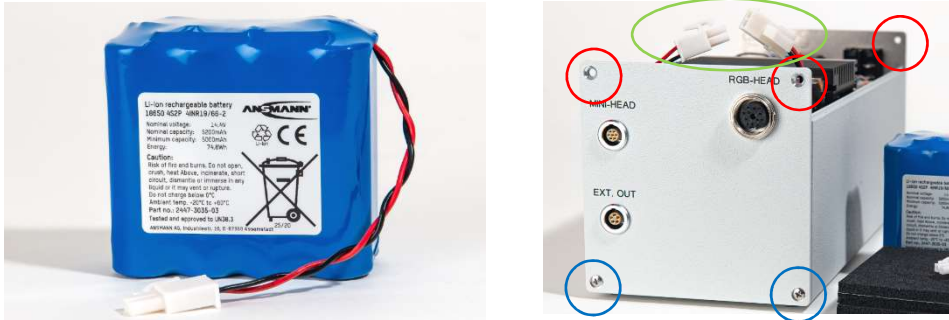

When ordered with WALZ, the battery is ready for installation. To change the battery, loosen the upper screws at front and back of the housing (red circles). Take off the housing cover. Disconnect battery! (See green circle.) Unscrew the screws at the bottom of the rear panel (blue circles).

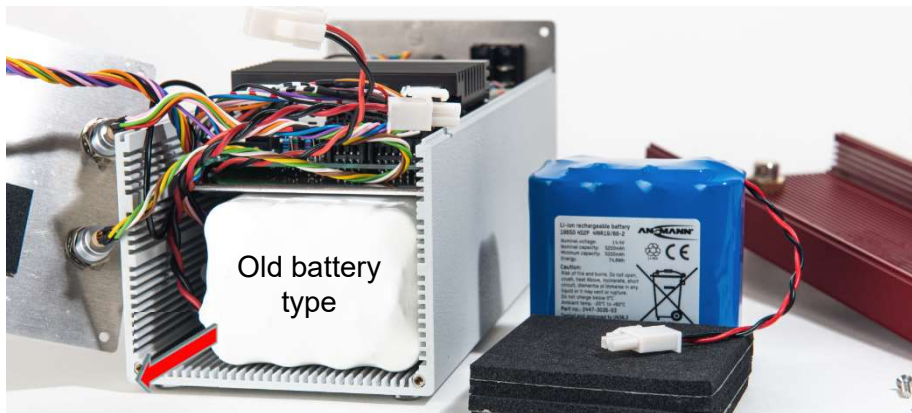

Remove rear panel and put aside. Pull out old battery.

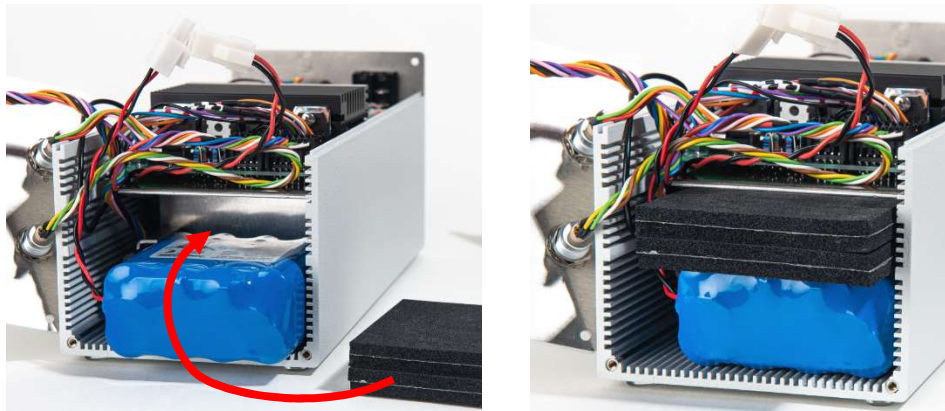

Insert new battery as shown. Foam plates, supplied with the battery, must be inserted above the battery. The battery can now be connected, and the housing reassembled. When closing the housing, take great care that wires and cables are not pinched.

## New Battery for IMAG-CM and IMAG-CG from 2021 onwards

Ansmann Battery 4S2P 14.8V/5.2Ah - Walz Order Nr. 000160101441

### Instructions for batteries not obtained from Walz

NOTE: Walz cannot be held responsible for direct or indirect damages resulting from improper handling or mounting of the replacement battery.

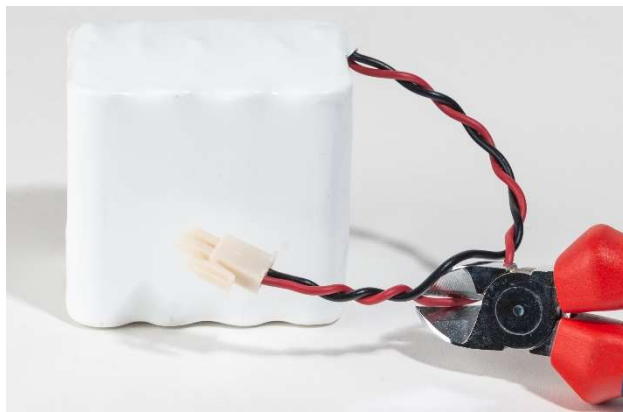
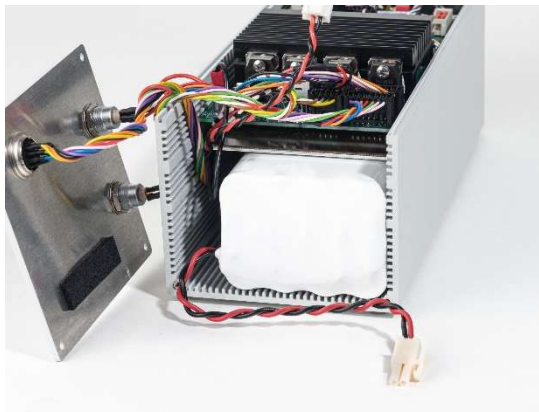

When purchased elsewhere, the 4S2P 14.8V/5.2Ah battery must be adapted to the connector of the IMAG-CM or IMAG-CG unit. To this end, remove the old battery as described on previous page. Individually cut the red and the black wire. Avoid short circuiting. Keep the disconnected plug.

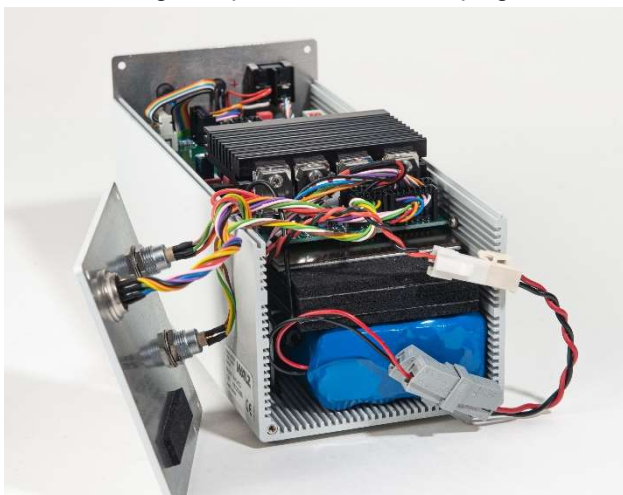

Strip end of wires. Use wire connectors to connect wires of the new battery to the wires of the old battery's plug. Connect wires of the same color. Make sure that the wires are firmly connected. Loose wire ends can get in contact with the housing or electrical circuits and entail serious damage.

The new battery type is smaller than the old one. Use antistatic foam material to completely fill the battery slot. The foam must fit tightly to prevent battery movement during transport which can lead to mechanical damage. Do not pinch wires and cables during assembly.